



Black

**PRODUCT FEATURES**

1. Modularization pluggable technology, free on-site maintenance tools.
2. Low cellular cooling technology and high thermal conductivity, the whole structure of the cooling chip, efficiency heat conduction and heat dissipation performance.
3. Low single star LED light damage does not affect the other light source current.
4. Intelligent constant current drive technology, output stability, break through the life of power, can be automatically adjusted light.
5. Optical compartment IP65 and IK08 protection, great level of protection against water and impacts.
6. Constant Light Output (CLO), uniform distribution of light over time.
7. Free series, full power solutions.

**PRODUCT ICONS FEATURE**



**General Information**

Product Range: Street lighting  
 Product Family: Urban lighting  
 Product Model: Atlas  
 Series Reference: EK8AT8  
 Warranty: 5 years  
 Lifespan @ Ta=25°C: L70 - L80 F10 100.000 h  
 Lifespan @ Ta=40°C: L70 - L80 F10 60.000 h

**Electric Specifications**

Voltage (V): 80-265V AC  
 Frequency (Hz): 50-60 Hz  
 Power Factor (PF): >0.95  
 Power Efficiency (PE %): >90%  
 Flicker (%): 0%  
 Total Harmonic Distortion (THD %): <20%  
 Protection Class: II

**Light Specifications**

System Luminous Efficacy (lm/W): 120-130 lm/W ±10%  
 Color Render Index (CRI >Ra): 80  
 Controlled Color Temperature ( CCT °K): 2200K-6000K  
 Color Consistency (SDCM): <5  
 Unified Glare Rating (UGR): <12  
 Beam Angle (Degrees): Different options regarding lens type  
 Upper Light Output Ratio (ULOR %): 0%

**Protection Specifications**

Optical Compartment Tightness (IP): IP66  
 Auxiliary Compartment Tightness (IP): IP66  
 Impact Resistance (IK): IK08  
 Surge Protection: Basic: 4kV/Extended 10kV

**Application Conditions**

T1 Temperature (°C): <40°C @ Ta=25°C  
 T2 Temperature (°C): <15°C <40°C @ Ta=25°C  
 Storage Temperature (°C): -40°C +85°C  
 Operating Temperature (°C): -40°C +50°C  
 Operating Humidity (RH%): 5-95%RH

**Control And Communication**

Constant Light Output (CLO): Optional  
 Scheduled Dimming System: 8 levels steps, Optional  
 Dimming Function: 0-10V/PWM/DAI (optional)  
 Other Sensors Options: Photoelectric, Movement, Other  
 Wireless Communications Compatibility: Yes

**Installation And Maintenance**

Type: Top fitting  
 Fitting To Existing Pole: Yes  
 System: Fitting SA/75mm diameter pole  
 Vertical Angle Adjustment: No  
 Mounting Height: 4-8M  
 Horizontal Angle Adjustment: No  
 Replaceable Light Source: Yes  
 Replaceable Driver: Yes  
 Replaceable Lens: Yes  
 Replaceable Cover: Yes  
 Heating Opening System: Stainless steel screws  
 Wire Connectors System: Waterproof threaded fastener connector

**PCB**

PCB Type: MC PCB  
 PCB Material: Aluminium  
 Thermal Vias: Yes  
 Led Bypass Protection: Yes  
 Overheating Protection: NTC Thermistor

**LED**

Brand: PHILIPS  
 Type: SMD  
 Model: S050  
 Min. Luminous Efficacy (lm/W): 150 lm/W

**Driver**

Brand: Inventronics  
 Series Type: EUC330, Other series optional  
 Internal or External: External  
 Isolated or Not: Isolated  
 IP: IP67  
 Lifespan @ Ta=40°C: 100.000 h  
 Surge Protection: 4 kV, 10kV  
 Overload and Short Circuit Protection: Yes  
 Thermal Feedback Control: Optional

**HeatSink**

Thermal Interface Material (TIM): Yes  
 Body Material: Aluminium  
 Fin Material: Aluminium  
 Extra Cooling System: The whole structure of radiation

**Housing**

Body Material: Aluminium finished  
 Finishing: Aluminium  
 Color:RAL, Black  
 Cover Material: PC,Lens  
 Cover Type: Diffuser  
 Locking System: Stainless steel screws

**Optical**

Lens Material: PC  
 Reflector Material: Anodized Aluminium  
 Diffuser Material: PC diffuser

**Wire Connection**

Cable Material: 3\*1,0mm rubber with cold pressed terminal  
 Connectors System: Waterproof threaded fastener connector  
 Waterproof Connectors: Yes

**Matters Need Attention**

- Matters need attention:
1. Before use, should carefully read the instructions, to avoid accidents and damage.
  2. Please wear gloves to avoid injury before installation work.
  3. Lighting installation, and wiring work must be carried out in the absence of power.
  4. Power line joints must do insulation, waterproofing treatment.
  5. Do not look directly at the light emitting LED lighting in close distance, ensures not hurt the eyes.

**APPLICATION**

- Parks
- Lighting of avenues
- Streets
- Roadabouts
- Squares



PRODUCT PARAMETERS

Reference	System Power	H <sup>2</sup> (mm)	Diameter (mm)	System efficacy (lm/W)	Reference Flux (lm)				System maintenance @ T <sub>a</sub> 25°C	T <sub>c</sub> (°C) T <sub>a</sub> 25°C	Reference Weight (kg)	
					IP 20/25/30	IP 40/45/50	IP 55/60/65	IP 70/75/80				
URBATE	20W	12	80mm	120 lm/W @120%	2475	3034	2726	2937	100 F10 100 000h	<+10°C	802P-020mm	7.5
			104mm	125 lm/W @120%	3070	3788	3345	4051	100 F10 100 000h	<+9°C		
			130mm	125 lm/W @120%	4070	4982	4395	5227	100 F10 100 000h	<+7°C		
	30W	16	78mm	120lm/W @120%	3654	3990	4045	4389	100 F10 100 000h	<+10°C		
			104mm	125 lm/W @120%	4760	5086	5140	5481	100 F10 100 000h	<+9°C		
			130mm	122lm/W @120%	5760	6129	6186	6662	100 F10 100 000h	<+9°C		
	40W	24	80mm	120 lm/W @120%	4860	5268	5470	5873	100 F10 100 000h	<+12°C		
			104mm	127lm/W @120%	6645	7123	7480	8028	100 F10 100 000h	<+10°C		
			128mm	125 lm/W @120%	7140	7698	7998	8543	100 F10 100 000h	<+9°C		
	60W	32	78mm	120lm/W @120%	7161	7780	8078	8678	100 F10 100 000h	<+10°C		
			104mm	125 lm/W @120%	9520	10220	10520	11200	100 F10 100 000h	<+9°C		
			130mm	122lm/W @120%	11019	11827	12328	13161	100 F10 100 000h	<+7°C		

PRODUCT CONFIGURATOR

Light	Mount	Color CCT	Voltage	Light	Control	Accessories
URBATE	30W	AMR2	120V-120V	LB01	0-10V	ESPE001
	30W	AMR2	100V-120V	LB01	0-10V	ESPE001
	30W	AMR	100V-240V	LB02	CLD	ESPE001
	40W	CW	100V-240V	LB03	Constant Light Output	PW-10000KVV
	60W	NW	170V-305V	LB03	CTLED0	External surge protection device 20kV
	60W	NW	240V-520V	LB04	0-5V/0-12V(PWM)/Timer	ESPE001
60W	PW	100V-240V	LB05	CTLED0-SD0	PW-50K	
	NW	100V-240V	LB05	0-12V(PWM)/Timer	External surge protection device 20kV	
	NW	100V-240V	LB06	DALI	ESPE001	
	NW	100V-240V	LB06	Digital Addressable Lighting Interface	ESPE001	
60W	NW	100V-240V	LB07	DMX003	ESPE001	
			LB07	Control of lighting and effects of the stage		
			LB07	0-10 control		
			LB08	0-10 control		
60W	NW	100V-240V	LB09	0-10V	ESPE001	
			LB09	0-10V control		
			LB09	0-10V control		
			LB09	0-10V control		

LIGHT DISTRIBUTION IMAGE

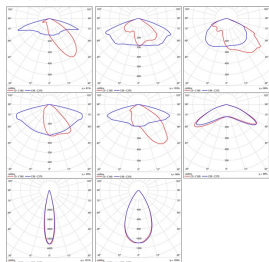

Accessories

PRODUCT DIMENSIONS



MOUNTING INSTRUCTIONS

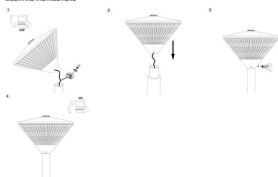

## PACKING SPECIFICATIONS

Model	Height	Long (mm)	Width (mm)	Depth (mm)	Net Weight (kg)
ENURAT020W12	2	600	600	430	9
ENURAT020W12	3	600	600	430	9
ENURAT040W12	2	600	600	430	9
ENURAT040W12	3	600	600	430	9
ENURAT040W14	2	600	600	430	9
ENURAT040W14	3	600	600	430	9
ENURAT040W15	2	600	600	430	9
ENURAT040W14	3	600	600	430	9
ENURAT060W14	2	600	600	430	9
ENURAT060W14	3	600	600	430	9
ENURAT060W15	2	600	600	430	9
ENURAT060W15	3	600	600	430	9
ENURAT080W15	2	600	600	430	9
ENURAT080W15	3	600	600	430	9

## MATTERS NEED ATTENTION



1. Before use, should carefully read the instructions , to avoid accidents and damage.
2. Please wear gloves to avoid injury before installation work.
3. Lighting installation and wiring work must be carried out in the absence of power.
4. Power line joints must do insulation and waterproofing treatment.
5. Do not look directly at the light emitting LED lighting in close distance, ensure not hurt the eyes.